

FILED ON:  
11/11/2025 03:52 PM  
CORTNEY BRITTEN CLEEREMAN  
REGISTER OF DEEDS  
FOREST COUNTY WI  
PAGES: 1

U.S. PUBLIC LAND SURVEY MONUMENT RECORD

This form is intended and designed to fulfill all requirements of Wisconsin Administrative Code, Chapter A-E 7.08 U.S. Public Land Survey Monument Record (3) (a)(b)(c)(d)(e)(f)(g)(h)(i).

The coordinate value shown has been verified by at least one of the following methods: 1) Comparison to a previously GNSS determined published value; 2) The value is the average of two or more GNSS observations at a markedly different time; 3) One or more distances were measured back to the GNSS observed corner from temporary GNSS observed offset locations.

A-E 7.08(3)(a) Identity of the corner:

E 1/4 Corner Section 17	WISCRS - Forest County
Township 34 North	N: 519396.896 USFT
Range 13 East	E: 840880.517 USFT
Town of Nashville	Datum: NAD 83 (2011)
County of Forest	GNSS Method: WISCRS VRS Direct Observation

Corner ID: 43413172000

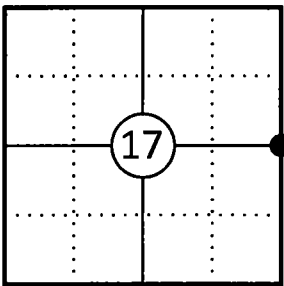

Original Corner Information:

Original Surveyor: J.L. Nowlin	Original B.T.'s: Birch 8" - N37°W, 6 links
Date of Survey: October 1865	Birch 22" - S30°E, 50 links

A-E 7.08(3)(b)(e)(f)(g) Describe any record evidence, monument evidence, occupational evidence, testimonial evidence or any other material evidence considered. Describe any discrepancy between the corner restored and any previously established location. State whether the corners was restored through acceptance of obliterated evidence, a found perpetuated location, or determined by proportionate methods.

- 11/23/1983 Certified Land Corner Restoration by Glen Barker indicates he set a 2 1/2" aluminum A-1 Forest County monument with alloy cap by doubling over from the north sixteenth corner. Note: It appears he has a typo in the section corners he notes in his tie sheet. He made four bearing trees. (See corner form for prior history and additional information).
- 10/08/2025 I found and accepted a Forest County aluminum monument with a 3" dia. cap stamped to identify the corner 8" above grade at the corner location and all four of Barker's bearing trees. I witnessed the corner as shown below.

A-E 7.08(3)(c)(d)(e)(h) Plan view of corner with ties to at least four witnesses. If in disagreement with previously established corner, show the distances between the two corners and also indicate the tie to the disputed corner. Distances and directions to other PLSS used as evidence or for proportioning.

Bearings given to the nearest second are Forest County Grid. All other bearings are magnetic

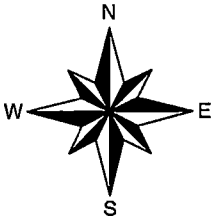
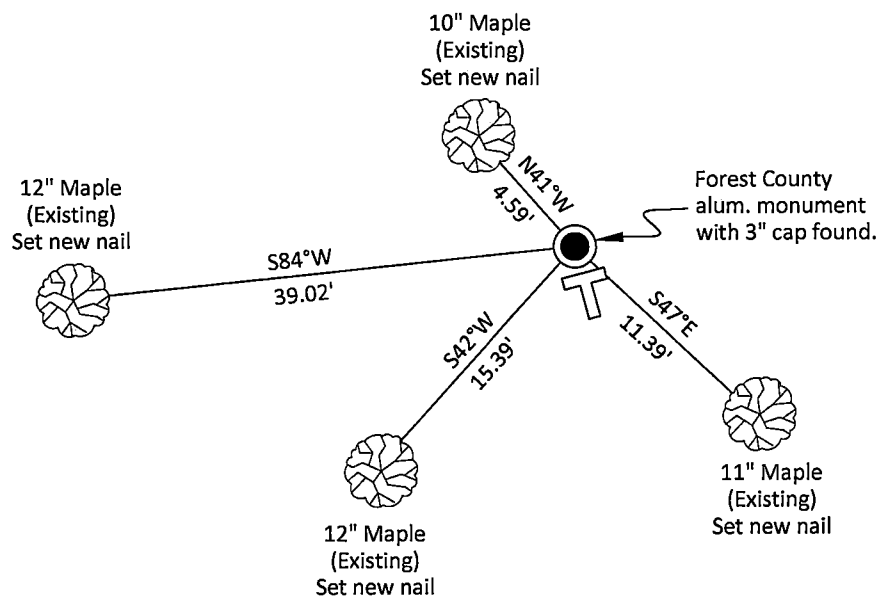

- \* Vinyl "T" post 0.8' southeast of corner.
- \* Distances to bearing trees are to nail in side with BT tag on tree.
- \* Sketch is not to scale

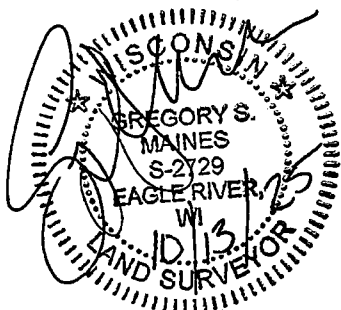

A-E 7.08(3)(i) - Certification  
I, Gregory S. Maines, Professional Land Surveyor No. 2729, hereby certify that the corner location on this record was referenced by me or under my direction and control and that this U.S. Public Land Survey Monument Record is complete to the best of my knowledge and belief.

43413172000

Index No.: 19

Stock No. 26272  
FORM 985  
H.C. Miller Company  
Surveyors, Instrumentalists

State of Wisconsin }  
County of Forest } ss.

I Glen Barker, do hereby  
certify that on the 22nd day  
of September, 19 83, I found  
evidence of the Quarter  
corner of Sections 16 & 17  
Township 34, North, Range  
13 East, Fourth Principal Meridian,  
as described hereon; and that from this evidence  
I established a new monument and accessories  
as described hereon to perpetuate the original  
location of this corner.

Resident witnesses:

J. Claflin - RL

H. Wagoner

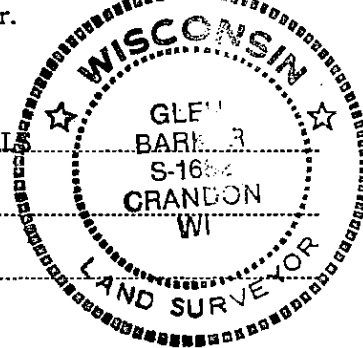

T34N

R13E

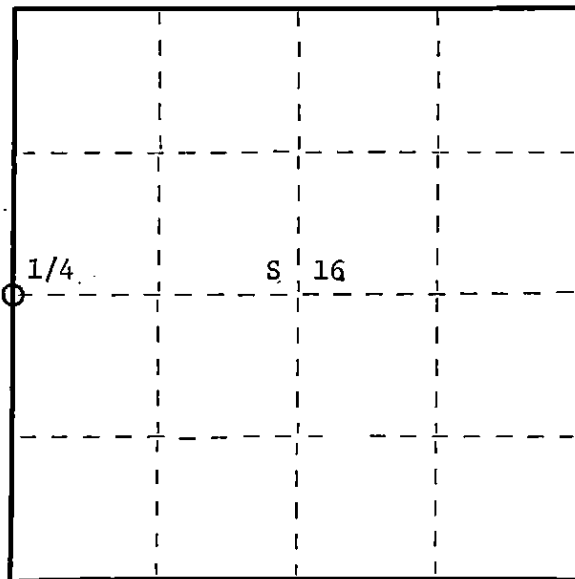

○ = Corner monument restored.

## CERTIFIED LAND CORNER RESTORATION

Index No. L-9

History of original corner establishment:

Original corner established in 1865 by James L. Nowlin, Gov. Deputy Surveyor  
from which birch 8" bears N37W 6 lks and birch 22" S30E 50 lks.

Description of corner evidence found:

Recovered a very old cedar post for N 1/16 between Sections 16 & 17 squared and  
scribed. Ran from old N 1/16 to Section corner 8-9-16-17 for a distance of 1315.34 ft.  
Doubled distance (2630.68) from Section corner on extended alignment.  
Set 1/4 corner. From this position found a large sugar 20" with north-south line  
blazes. On the recovered evidence reestablished 1/4 corner.  
Corner sets 2630.68 ft. of Sec. Corner 9-10-16-17 and 2605.18 ft. of Sec. Corner  
9-10-16-17.

Description of monument and accessories I established to perpetuate the original location of this corner.

Set a 2 1/2" A-1 Forest County monument with alloy cap stamped: T34N R13E

Monument projects 8" above ground.

Marked NBTs

Sugar 6" N45W 4.42 ft.)

Sugar 4" S47E 11.94 ft.)

Sugar 6" S41W 15.78 ft.) - Scribed 1/4 - B.T.

Sugar 6" S84W 39.18 ft.)

Ties to #16 nail center of tree

1/4 17 16  
S1682 - 1983

Dated at Rhineland, Wis., this 23rd day of November, 19 83

Signature Glen Barker Title Registered Land Surveyor Registration No. S1682  
(County Surveyor, Registered Land Surveyor, or other duly authorized official)

Office of Register of Deeds, County of Forest, I hereby certify that the within  
instrument was filed in this office for record on the 22nd day of February, 19 84  
at 11:00 o'clock A. M.

Eugene Stangor  
(Register of Deeds)  
By \_\_\_\_\_ Deputy

DOCUMENT NO. 125204

43413172000