

U.S. PUBLIC LAND SURVEY MONUMENT RECORD

This form is intended and designed to fulfill all requirements of Wisconsin Administrative Code, Chapter A-E 7.08 U.S. Public Land Survey Monument Record (3) (a)(b)(c)(d)(e)(f)(g)(h)(i).

The coordinate value shown has been verified by at least one of the following methods: 1) Comparison to a previously GNSS determined published value; 2) The value is the average of two or more GNSS observations at a markedly different time; 3) One or more distances were measured back to the GNSS observed corner from temporary GNSS observed offset locations.

A-E 7.08(3)(a) Identity of the corner:

SE Corner Section 22	WISCRS - Forest County
Township 34 North	N: 511715.620 USFT
Range 13 East	E: 851286.099 USFT
Town of Nashville	Datum: NAD 83 (2011)
County of Forest	GNSS Method: WISCORS VRS Direct Observation

Corner ID: 43413220000

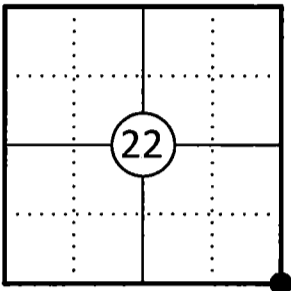

Original Corner Information:

Original Surveyor: J.L. Nowlin	Original B.T.'s: W Pine 18" - N60°E, 25 links
Date of Survey: October 1865	W Pine 22" - S8°E, 20 links

A-E 7.08(3)(b)(e)(f)(g) Describe any record evidence, monument evidence, occupational evidence, testimonial evidence or any other material evidence considered. Describe any discrepancy between the corner restored and any previously established location. State whether the corners was restored through acceptance of obliterated evidence, a found perpetuated location, or determined by proportionate methods.

- 11/15/1963 Restoration of Lost Original Government Survey Corner by Neal Sperhake indicates he set a 1" dia. iron pipe with a Kimberly Clark Corp aluminum cap at a fence line intersection and made four bearing trees. (See corner form for prior history and additional information).
- 10/08/1998 Glen Barker, Forest Co Surveyor File # 341322-19981008 found a 1" dia. iron pipe w/4" alloy cap.
- 04/24/2025 I found and accepted a 1-1/4" dia. iron pipe with a Kimberly Clark Corp 4" dia. aluminum cap stamped to identify the corner 12" above grade at the corner location approximately 15' south of a beaver pond. We did not find any of Sperhake's bearing trees. I made four bearing trees and witnessed the corner as shown below.

A-E 7.08(3)(c)(d)(e)(h) Plan view of corner with ties to at least four witnesses. If in disagreement with previously established corner, show the distances between the two corners and also indicate the tie to the disputed corner. Distances and directions to other PLSS used as evidence or for proportioning.

Bearings given to the nearest second are Forest County Grid. All other bearings are magnetic

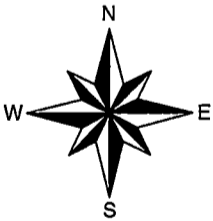
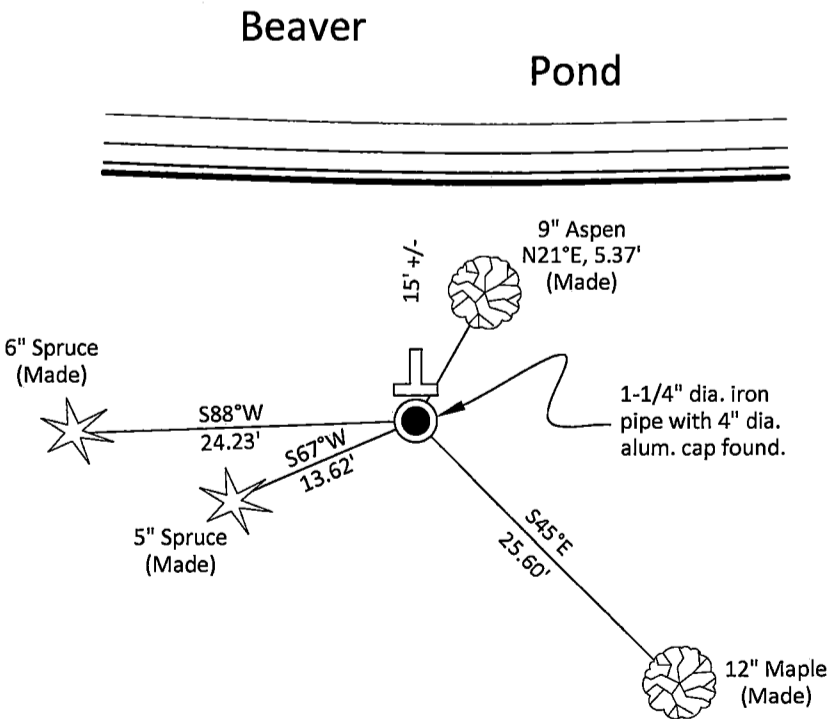

- * Vinyl "T" post 1.0' north of corner.
- * Distances to bearing trees are to nail in side with BT tag on tree.
- * Sketch is not to scale



A-E 7.08(3)(i) - Certification
I, Gregory S. Maines, Professional Land Surveyor No. 2729, hereby certify that the corner location on this record was referenced by me or under my direction and control and that this U.S. Public Land Survey Monument Record is complete to the best of my knowledge and belief.

Index No.: R17

State of Wisconsin }
County of FOREST } ss. RESTORATION OF LOST ORIGINAL GOVERNMENT SURVEY CORNER.

I NEAL SPERHAKE, do hereby certify that on the FIFTEENTH day of NOVEMBER, 19 63, I established the NORTHWEST SECTION CORNER OF SECTION 26, TOWNSHIP 34 NORTH, RANGE 13 EAST, Fourth Principal Meridian, as described hereon.

History: This corner was established during the original survey of this township, as noted in the original field notes for the original survey of T34N-R13E, 4th. p.m.

Description of monument and accessories I established to perpetuate the location of this corner:
At the point determined for the location of the corner I emplaced a:
GALVANIZED IRON PIPE, THREE FEET LONG, ONE INCH IN DIAMETER, WITH ALUMINUM CAP DENOTED AS, "KIMBERLY-CLARK CORP. T34N 22, 23, 26, 27 R13E. SPERHAKE RLS 463 11/15/63."

The pipe is witnessed by:
W. Birch 4 N 60°W 12½ links. (SCRIBED S22 NBT).
W. Birch 7 N 20°E 208 links. (SCRIBED S23 NBT).
W. Pine 15 S 11°E 70 links. (SCRIBED S26 NBT).
W. Birch 4 S 40°W 14 links. (SCRIBED S27 NBT).

Description as to how corner was located: A fence running north between 26 and 27 junctions with a fence running east between 23 and 26. This point is 85.88 chains north of the corner of 26, 27, 34, 35, and 78.69 chains south of the corner of 14, 15, 22, 23 and 39.60 chains west of the quarter section corner between 23 and 26, and 81.53 chains east of the corner of 21, 22, 27, 28. Judging from the chainages the fence corner would not be marking the section corner of 22, 23, 26, 27. However, the original survey was so erratic in this area that proportionate measurement cannot be used. Of importance to note is the fact that at this junction this fence is extremely well constructed, and very straight. In addition, a pine with a scarred face, though too badly burned to positively identify as a bearing tree, does lie in the exact position of a bearing tree noted in the original field notes as "W. Pine 18 N 60°E 25". The other tree was a "W. Pine 22 S 8°E 20". At exactly this bearing and distance from the fence junction is a large depression in the ground typical of those often formed when a large tree blows over and the roots pull up out of the ground. The rest of the form of the tree is identifiable where it fell onto the ground. It is too badly decomposed to identify scars on it. I feel that it is not coincidence that such a well constructed fence would be built several chains away from the section lines, and that two trees, comparable to the original bearing trees, would also be in just a coincidental position as denoted from the original field notes. I believe the fence junction marks the site of the original corner, and the fact that the fence was built over thirty years ago provides the probability that at least one of the original bearing trees was decipherable at that time.

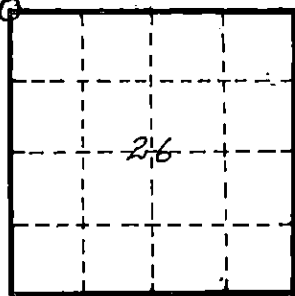

0 = Corner monument restored

Subscribed & sworn to before me this 25 day of Aug 1964
Anna Peterson
NOTARY PUBLIC, FOREST CO., WIS
COM. EXPIRES 10/31/65

Resident witnesses _____
Dated at Grandon, Wisconsin, this 25 day of Aug, 19 64.
Signature Neal Sperhake
Title Registered Land Surveyor Registration No. 463

Office of Reg. of Deeds County of Forest
I hereby certify that the within instrument was filed in this office for record on the 25 day of Aug 19 64, and was filed in Book No. Page No. of County Records.

Surveyor's Seal

Signature Anna Peterson Title Reg. of Deeds

43413 220000

88987
Index No: R-17
R-17