

245857

FILED ON:

06/06/2025 03:37 PM

CORTNEY BRITTEN CLEEREMAN

REGISTER OF DEEDS

FOREST COUNTY WI

PAGES: 1

FOREST COUNTY U.S. PUBLIC LAND
SURVEY MONUMENT LOCATION RECORD

☒ LANDMARK ☐ BENCHMARK
CORNER IDENTITY: BERNTSEN SNM-1 STEEL NAIL MARKER

FOUND ☒
SET ☐
RESET ☐
RE-TIED ☒

FOREST COUNTY COORDINATE: N: 537171.248
E: 894181.579

ELEVATION-(FEET): _____ DATUM: NAD83 (2011)

WEATHER: LIGHT RAIN

DATE OF SURVEY: 8/10/2021 TEMPERATURE: 80 °F

SURVEY PARTY: KEITH WALKOWSKI & COLLIN MARQUARDT

SECTION 25
TOWNSHIP 35 N
RANGE 14 E

LAONA

CITY, VILLAGE, TOWN

SECTION

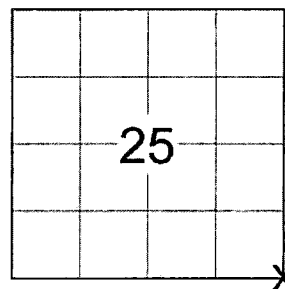

LOCATION
(Indicated By X)

V-25

NO.

BASIS FOR MONUMENT LOCATION:

(DESCRIBE METHOD OF SURVEY AND CORNER AUTHENTICATION)

SEARCHED FOR THE SOUTHEAST CORNER AND COULD NOT FIND A CORNER MONUMENT BUT DID FIND 3 TIES FROM THE RECORD 1985 TIE SHEET. INTERSECTED THE TIES AND SET A BERNTSEN SNM-1 STEEL NAIL MARKER UPON COMPLETION OF THE STATE HIGHWAY "32" RESURFACING PROJECT. SET AN ADDITIONAL TIE TO THE NORTHEAST TO PERPETUATE THE CORNER LOCATION AS SHOWN BELOW.



CERTIFIED CORRECT:

Keith J. Walkowski

KEITH WALKOWSKI S-2717

Registered Land Surveyor

DATE: OCTOBER 18TH, 2021COMPANY RIVERSIDE LAND SURVEYING LLC

TIE SKETCH:

- ☒ - SET BERNTSEN SNM-1 STEEL NAIL MARKER
- ☒ - SET BERNTSEN SSDR130 30" STAINLESS DRIVE-IN MONUMENT WITH 1-1/2" CAP
- ☒ - FOUND BERNTSEN ALUMINUM CAPPED MONUMENT

BEARINGS ARE BASED ON THE FOREST COUNTY COORDINATE SYSTEM NAD 83 (2011) AND REFERENCED AS SHOWN

THIS DRAWING IS NOT TO SCALE



43514250000

V-25

NO.

ORIGINAL ON FILE IN CO CLERK'S OFFICE
COPY HERE FOR REFERENCE

FIELD SURVEY NOTES
PRESERVATION OF LANDMARKS
(Pursuant to Section 59.635(7) Wisconsin Statutes
E-D-707-69

State of Wisconsin / Department of Transportation

COUNTY		
FOREST		
TOWN		
LAONA, WABENO		
HIGHWAY		
STH 32		
SECTION	TOWNSHIP	RANGE
25	T 35 N	R 14 E
TYPE OF LANDMARK		
5/8" IRON ROD AGREES WITH USFS		

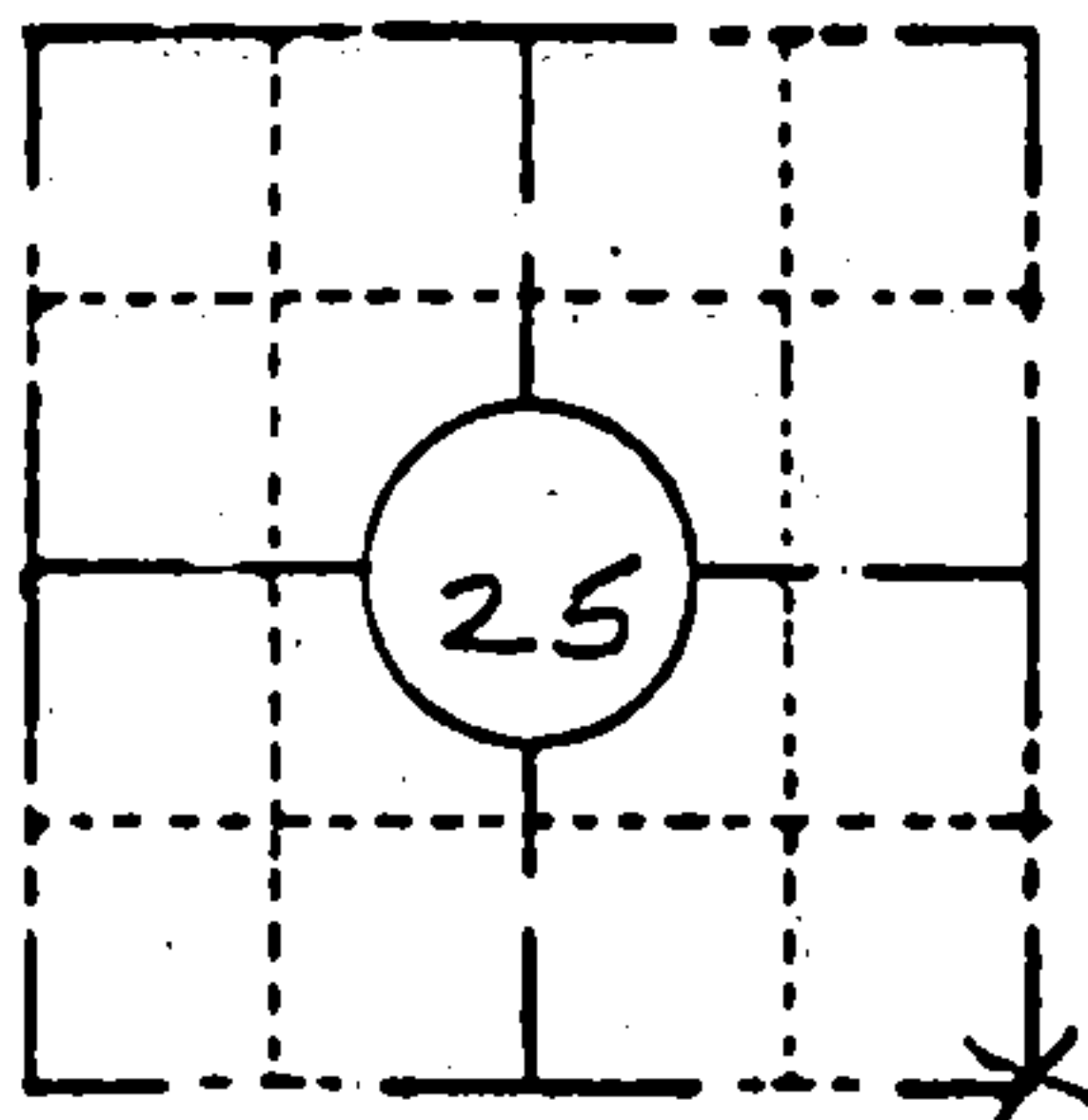

LOCATION SKETCH
(Location of landmark indicated by "x")

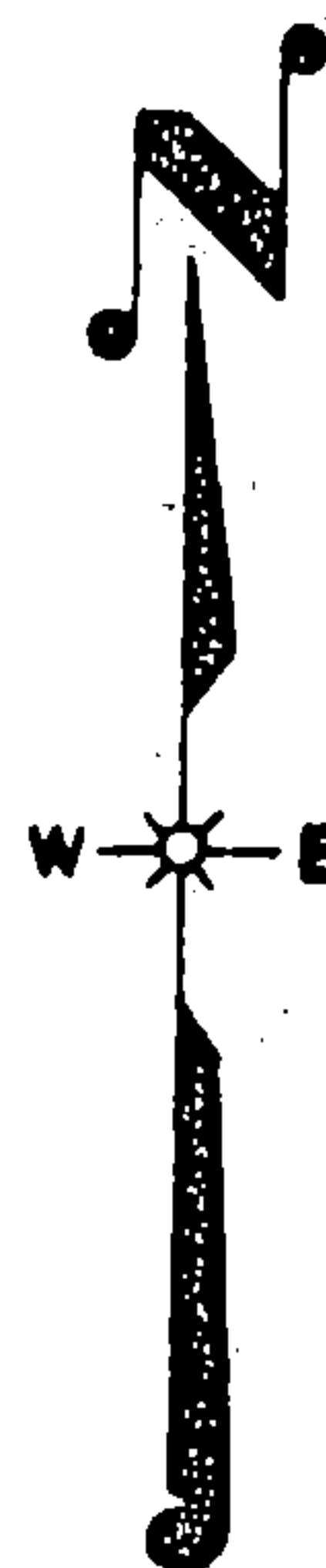

This space for copy of field notes or ties to the above described landmarks

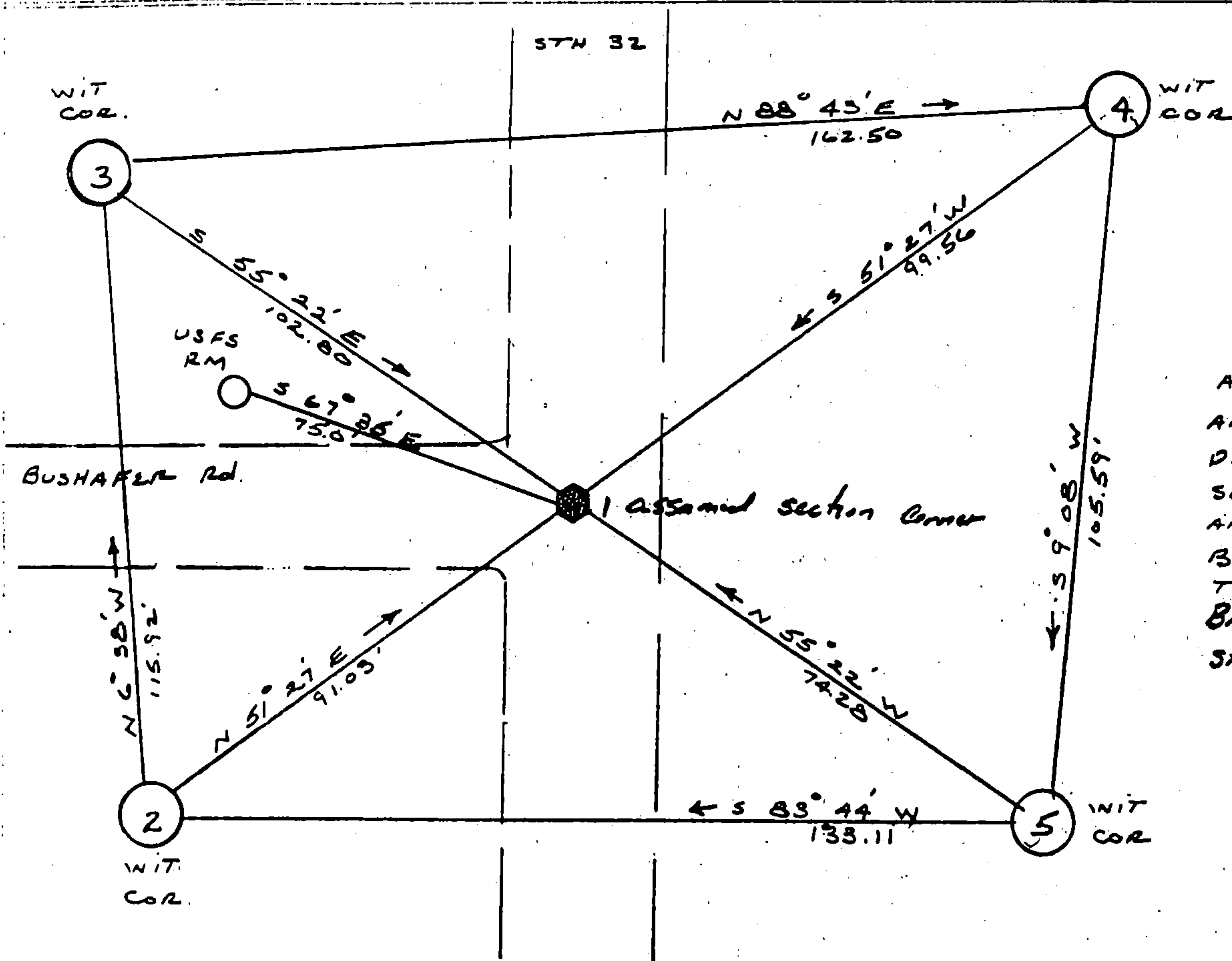

ALL WITNESS CORNERS
ARE D.O.T. BERNSTEN
DRIVEABLE MONUMENT.
SET FLUSH WITH GROUND
AND STAMPED WITH
BEARING & DISTANCE
TO CORNER
Brgs are referred to
STH 32 &

FILED UNDER PROJECT		
9131-03-70		
DISTRICT OFFICE NUMBER	CITY	COUNTY
03-07	RHINELANDER	ONEIDA
LOCATED OR ESTABLISHED BY		
NAME J.R. WALLIN		
TITLE SURVEY CREW CHIEF DATE 5-16-85		
Under the direct supervision of Michael Hess 502809		

COUNTY CLERK'S OFFICE	
COUNTY OF Forest	WISCONSIN } 53
DATE RECEIVED FOR RECORD	DATE COPY SENT TO COUNTY SURVEYOR
7-10-85	N/A
SIGNATURE OF COUNTY CLERK	
Dora C. James	

PRESERVATION OF LANDMARKS

PAGE

4351425 0000

V-25