



Stock No. 26273

158093

State of Wisconsin }  
County of Forest } ss.  
I Gary L. Pisoni, do hereby  
certify that on the 19th day  
of August, 1993, I found  
evidence of the Northwest Section  
corner of Section 12  
Township 36, North, Range  
14 East, Fourth Principal Meridian,  
as described hereon; and that from this evidence  
I established a new monument and accessories  
as described hereon to perpetuate the original  
location of this corner.

Resident witnesses:

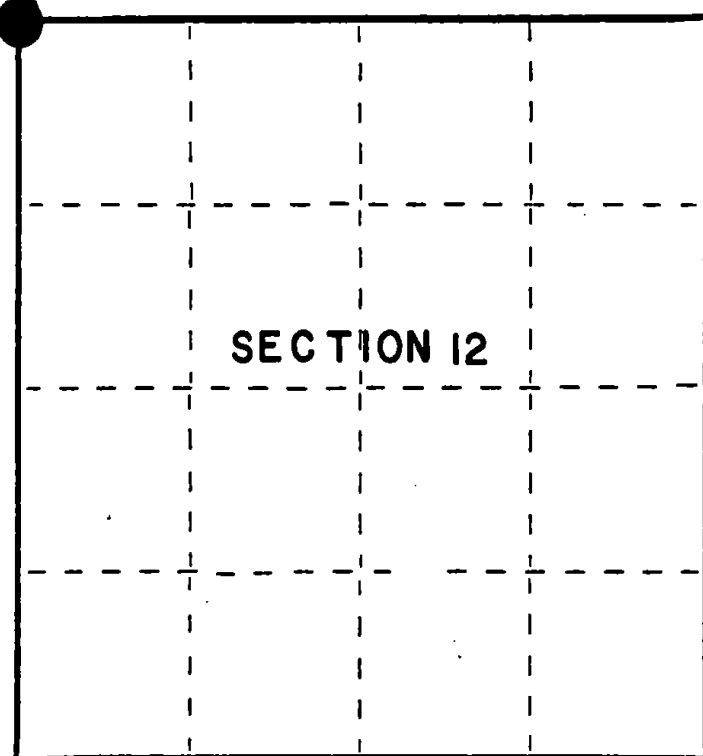

● = Corner monument restored.

CERTIFIED LAND CORNER RESTORATION

Index No. E-21

History of original corner establishment:

Original Government Survey in 1859 by James McBride, deputy surveyor. West corrected between Sections 1 and 12 at 79.80 chains, set Section corner post from which the following bear: Hemlock, 12", N 36°W, 28 lks; Hemlock, 16", N 38°E, 17 lks; Cedar, 12", S 61°E, 31 lks; Hemlock, 10", S 53°W, 60 lks.

In 1982, Daniel K. Pleoger RLS, found an old post point and an old Forest Service location tag on a nearby tree. He accepted the post point as the best available evidence for restoring the corner position. Replaced post point with a 2½" dia. aluminum pipe monument with an aluminum cap from which the following bear:

Description of corner evidence found:

Sugar	5"	N 67°E	8.30 feet
Sugar	8"	S 24°W	12.23 feet
Sugar	7"	N 61°W	23.98 feet

Found the monument and bearing trees as described above:

Sugar Maple	4"	N 68°E	8.49 feet
Sugar Maple	12"	S 25°W	12.90 feet
Sugar Maple	11"	N 60°W	23.44 feet

Description of monument and accessories I established to perpetuate the original location of this corner.

Blazed and scribed the following new bearing trees: (Measurements taken to a nail in side of tree)

Basswood	11"	S 68°W	25.71 feet
Steel sign post		N 14°W	1.24 feet

Dated at Iron River, MI, this 12th day of June, 1995

Signature Gary L. Pisoni Title Land Surveyor Registration No. S-1634  
(County Surveyor, Registered Land Surveyor, or other duly authorized official)

Office of Register of Deeds, County of Forest, I hereby certify that the within instrument was filed in this office for record on the 20th day of March, 1997 at 1:30 o'clock P. M.

(Register of Deeds)

By Paul J. Tinkering Deputy

158093 14020000

c) Describe any material discrepancy between the location of the corner as restored or reestablished and the location of that corner as previously restored or reestablished by distance and direction. Show the discrepancy on the plan view drawing under (d), above. Show the distances between the corner as previously restored or reestablished and (1) the corner as restored or reestablished, and (2) to at least 2 of the witness monuments shown on the drawing in (d), above.

None

(f) Was the corner restored through acceptance of (1) an obliterated evidence location, or, (2) a found perpetuated location?

Restored through acceptance of a found perpetuated location.

(gkh) Was the corner reestablished through lost corner proportionate methods? If so, show the method, including the directions and distances to other public land survey corners used as evidence or used for proportioning in determining the corner location?

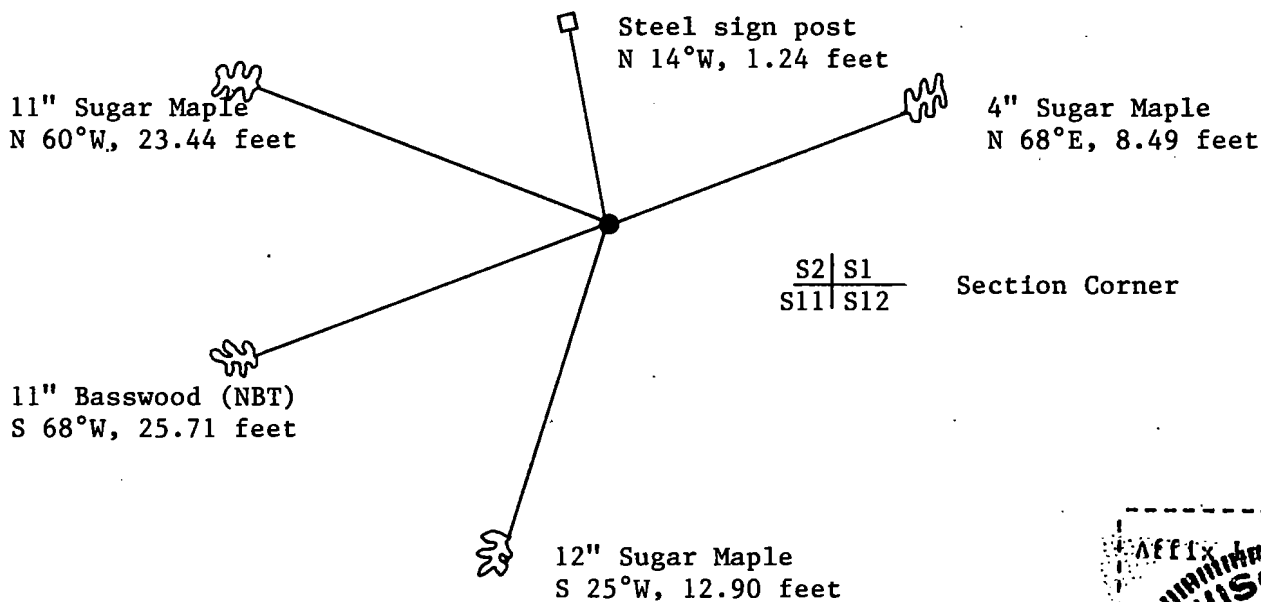

(i) I, Gary L. Pisoni  
(type or print name) certify that the corner location shown on this record was determined by me or under my direction and control and that this U.S. Public Land Survey Monument Record is correct and complete to the best of my knowledge and belief.

Signature

Gary L. Pisoni

Date

6-24-95

Survey requested by: \_\_\_\_\_

District Ranger

Date

CERTIFIED LAND CORNER RESTORATION

Index No. E-21

E 21

State of Wisconsin }  
County of Forest } ss.

I Daniel K. Pleoger, do hereby  
certify that on the 22nd day  
of March, 1982, I found  
evidence of the Section  
corner of Sections 1-2-11-12  
Township 36, North, Range  
14 East, Fourth Principal Meridian,  
as described hereon; and that from this evidence  
I established a new monument and accessories  
as described hereon to perpetuate the original  
location of this corner.

Resident witnesses:

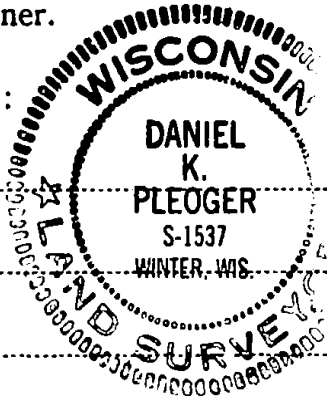

FORM 985 H. C. MILLER CO., MILWAUKEE

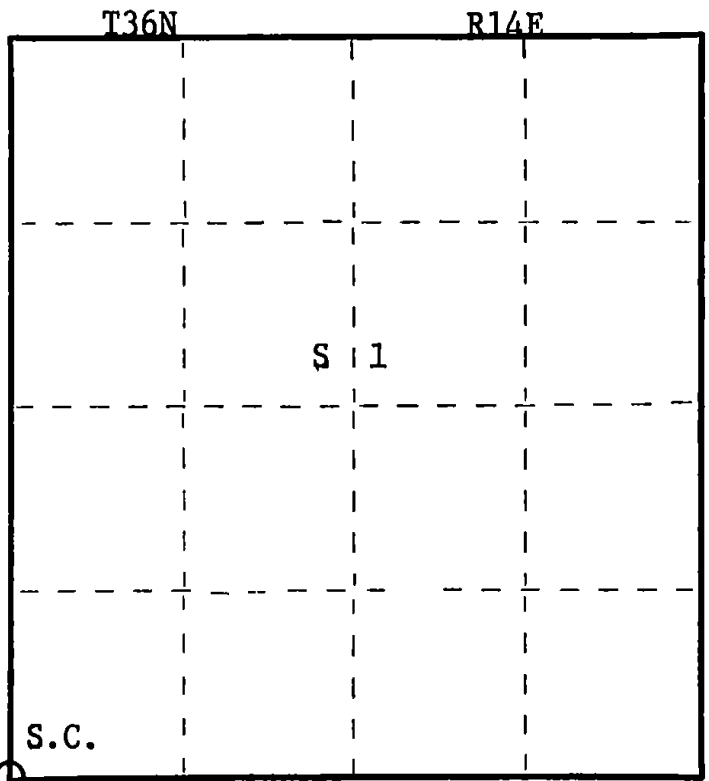

○ = Corner monument restored.

History of original corner establishment:

Original corner established by James McBride, Gov. deputy surveyor in 1859 from which  
hemlock 12" bears N36W 28 links, hemlock 16" N38E 17 links, cedar 12" S61E 31 links  
and hemlock 10" bears S53W 60 links.

Description of corner evidence found:

Recovered a piece of old post point, old blazed trees facing corner, an old forest  
service location tag on nearby tree, a very old blazed line running east and west  
from corner.

Description of monument and accessories I established to perpetuate the original location of this corner.

Set a 2½" A-1 federal monument with alloy cap stamped:

T36N R14E

Monument projects 12" above ground.

Marked NBTs:

Sugar 5" N67E 8.30 ft.

Sugar 8" S24W 12.23 ft.

Sugar 7" N61W 23.98 ft.

Scribed S.C. - B.T.

S.C.  $\frac{2}{11} \frac{1}{12}$

S1537 - 1982

Dated at Rhineland, Wis., this 18th day of May, 1982.

Signature Daniel K. Pleoger Title Registered Land Surveyor Registration No. 1537  
(County Surveyor, Registered Land Surveyor, or other duly authorized official)

Office of Register of Deeds, County of Forest, I hereby certify that the within  
instrument was filed in this office for record on the 15th day of June, 1982  
at 10:00 o'clock A. M.

Eugene Statezny

(Register of Deeds)

By Sharon Mueller Deputy

DOCUMENT NO.  
**121692**

43614020000