

**!Attention!**

This PLSS corner is in the process of being updated by Forest County. An updated Tie Sheet will be available for this corner soon.

Please contact Kayla at the Forest County Land Information Department for more information.

Contact Info:

715-478-1387 or [Kayla.L@co.forest.wi.us](mailto:Kayla.L@co.forest.wi.us)

CERTIFIED LAND CORNER RESTORATION

Index No. **X 5**

State of Wisconsin }  
County of Forest } ss.

I Thomas R. Arnott, do hereby  
certify that on the 13th day  
of June, 1976, I found  
evidence of the 1/4  
corner of sections 31 & 32  
Township 36, North, Range  
15 E, Fourth Principal Meridian,  
as described hereon; and that from this evidence  
I established a new monument and accessories  
as described hereon to perpetuate the original  
location of this corner.

Resident witnesses:

\_\_\_\_\_  
\_\_\_\_\_  
\_\_\_\_\_

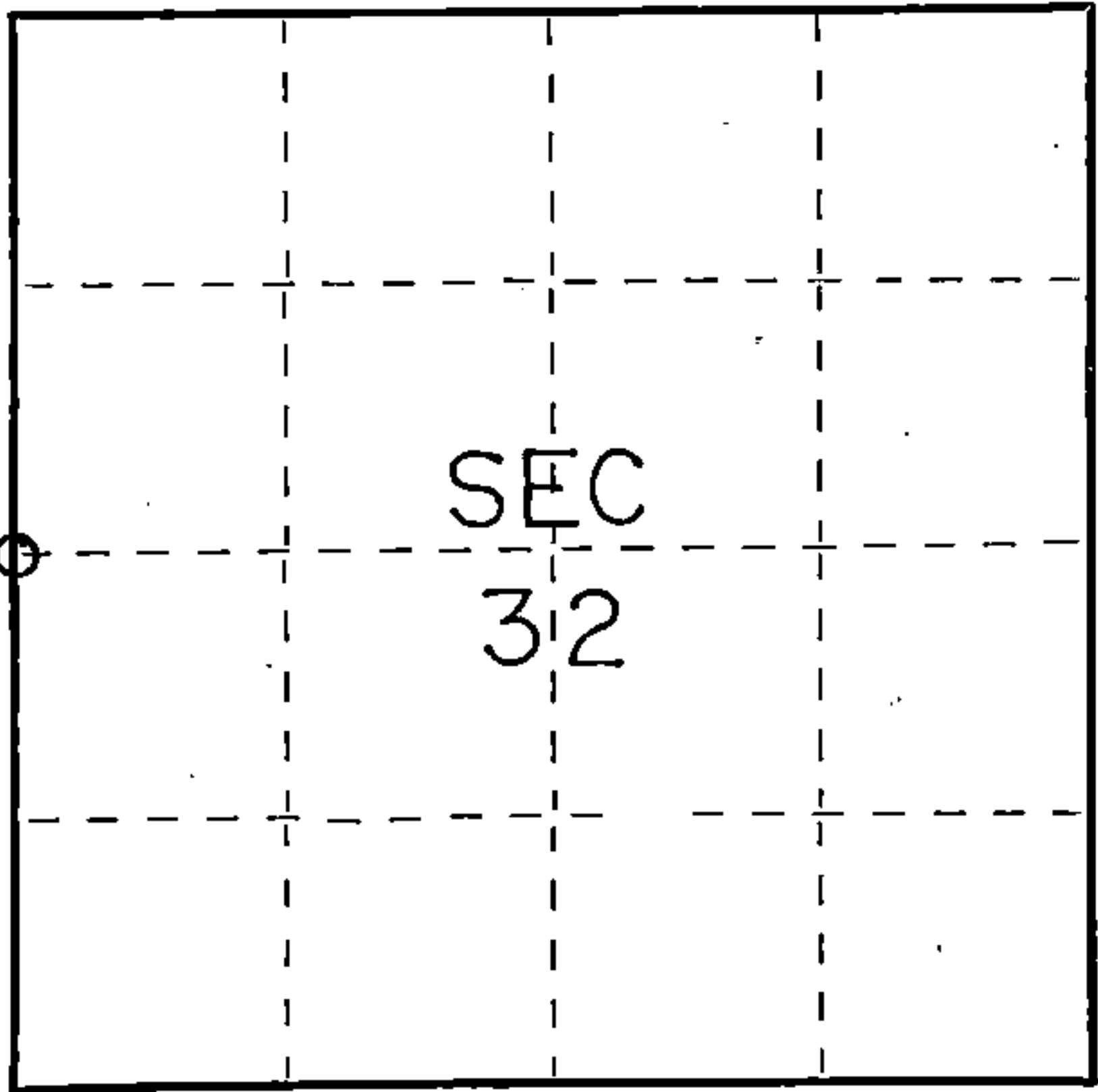

○ = Corner monument restored.

History of original corner establishment:

Original subdivision by James McBrid 17 Jul - 28 Jul, 1859

Sugar	10	West	8 Lks.
Sugar	8	S54E	9 Lks.

Description of corner evidence found:

Found  $1\frac{1}{4}$ " iron pipe also found  $1\frac{3}{4}$ " iron pipe .32 feet east

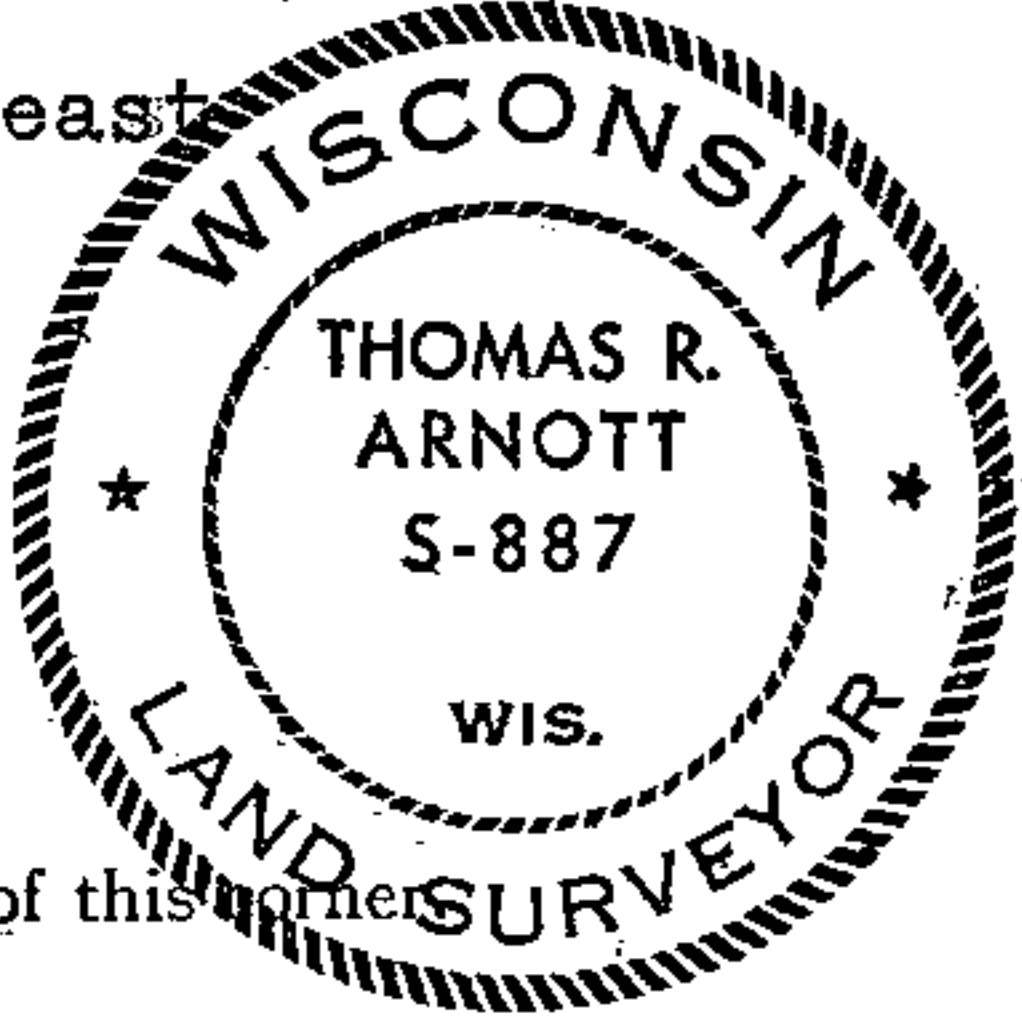

4215312000

Description of monument and accessories I established to perpetuate the original location of this corner

Replaced  $1\frac{1}{4}$ " iron pipe with new Forest County Aluminum Monument  
Left  $1\frac{3}{4}$ " iron pipe .32 feet east

Ties to Aluminum monument:

Power pole (3615-31E1)	N57W	38.80 feet
Telephone Pole	S37E	37.00 feet

Dated at Grandon, Wis., this 11th day of June, 1976

Signature Thomas Arnott Title Surveyor Registration No. S-887  
(County Surveyor, Registered Land Surveyor, or other duly authorized official)

Office of Register of Deeds, County of Forest, I hereby certify that the within  
instrument was filed in this office for record on the 11th day of June, 1976  
at 3 o'clock P. M.

EUGENE STATEZNY Document Number 109437  
(Register of Deeds)

By Eileen Schmidt Deputy